



The Fastest, Easiest Way to Install Electrical Systems

Facing sky-high labor costs and slow installation times for your electrical projects?

The Universal Mount Pro is your solution! ⚡

- Reduce Labor Costs by up to 70%
- Minimize Workplace Accidents with Secure Installations
- Eco-Friendly Design with Reduced Material Waste
- Ready for the Future of Smart Tech: WiFi, Sensors, and More
- Durable and Low-Maintenance: Minimize Downtime
- Revolutionize your electrical systems installations and product designs today!

Contact Us today to Learn More

📞 787.449.4040

✉ richie@prdss.net



US10122140B1

Universal Mount Pro Rosette

A Versatile Foundation for Innovation

Our revolutionary base system provides universal anchoring and coupling for a wide range of applications across various industries – from residential, commercial to marine, air, and other industries

Benefits:

- Streamlined Workflow: Simplifies technical work and reduces the need for specialized tools.
- Modular Design: Allows for easy exchange of parts and products, facilitating future upgrades and customization.
- Enhanced Safety: Improves safety protocols, minimizes accidents, and reduces electrical connection errors.
- Optimal Performance: Safeguards the integrity of installations, ensuring optimal functionality and longevity.
- Efficient Maintenance: Enables faster and more effective preventive maintenance.

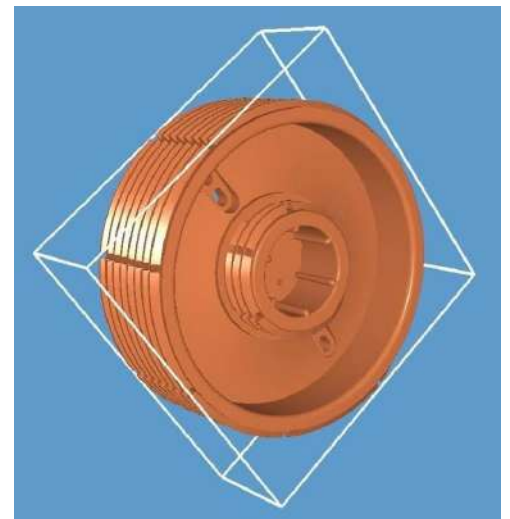



Universal Mount Pro Rosette Ring

Secure you wall and ceiling installations while improving the appearance. Conceal wiring and enhance the look of your installations with the Universal Mount Pro Rosette Ring



Universal Mount Pro Rosette Cover

Protects and enhances your electrical installations. Shields against the elements, prevents insect intrusion, and adds an aesthetic touch to complement any project



Universal Mount Pro Rosette Ring Pro

For enhanced security, choose the Universal Mount Pro Rosette Ring Pro with 2 secure locks

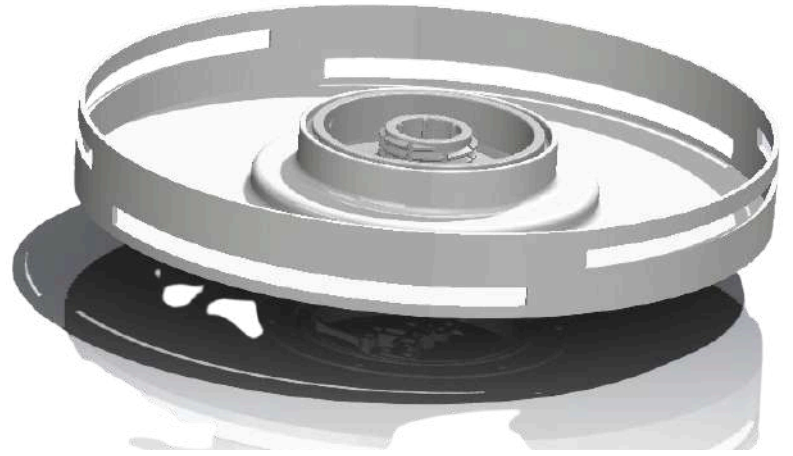

Universal Mount Pro | Lamp Designs

Quick and secure installation for endless designs - a must for cost cutting manufacturers, architects, profesional designers and more

Universal Mount Pro | Fan

Easier and safer mounting and dismounting for ceiling fans, simplifying maintenance | Our own desing with UMP included



Benefits by Category

Boost your bottom line and go green - Benefits for manufacturers

- Slash energy consumption throughout your production process.
- Reduce inventory costs and optimize warehouse space.
- Streamline manufacturing with fewer machines, tools, and labor.
- Accelerate production times for faster turnaround.
- Minimize packaging and transportation expenses.
- Improve product reliability and reduce warranty claims.
- Enhance your sustainability profile with eco-friendly products and 100% recyclability.
- Comply with OSHA environmental safety standards.

Revolutionize Your Marine Lighting Maintenance - Benefits for Marine / Outdoors Items

Tired of cumbersome, time-consuming, and costly lighting maintenance on your boat or aquatic structure?

- **Lightweight Design:** Reduces structural strain and simplifies installation.
- **Effortless Compliance:** Meets rigorous marine safety regulations.
- **Rapid Replacement:** Change out fixtures in record time.
- **Error-Free Installation:** Foolproof design ensures it's right the first time.
- **Enhanced Safety:** Minimizes electrical interruptions and promotes controlled maintenance.
- **Improved Comfort:** Cleaner and more controlled work areas, even in tight spaces.
- **Cost Savings:** Reduces the need for specialized equipment and maximizes existing tools.
- **Advanced Technology:** Boosts internet communication and security.
- **Unmatched Durability:** Rust-resistant and built for harsh marine environments.
- **Reliable Protection:** Robust, semi-hermetic system withstands water pressure and extreme temperatures

Safer, Smarter, More Durable Facilities - Benefits for residential and commercial market

- **Enhanced Safety:** Proactive inspections and rapid response minimize electrical and structural risks.
- **Increased Durability:** Versatile performance ensures resilience against displacement and water damage.
- **Reduced Costs:** Minimize maintenance, repairs, and downtime with long-lasting, lightweight, rust-resistant installations.
- **Certified Electrical Systems:** Expert certification upon project delivery guarantees safety and compliance.
- **Modernized Technology:** Stay ahead of the curve with cutting-edge technology integration.
- **Uninterrupted Operations:** Prevent electrical failures, short circuits, and costly downtime.
- **Streamlined Efficiency:** Multifunctional systems eliminate redundant equipment, maximizing savings.
- **Elevated Standards:** Maintain superior facility quality and operational excellence.
- **Weather-Resilient Infrastructure:** Swift response and proactive measures mitigate damage from weather events.